

NOTE: BREAK ALL CORNERS WITH 0.015" (.38 MM) RADIUS UNLESS OTHERWISE NOTED. STANDARD TOLERANCES TO APPLY UNLESS OTHERWISE SPECIFIED.

CUSTOMER PART No.	CUSTOMER CAN ART STD.	DIE No. ES05585
DESCRIPTION 15/16" HEX BAR	PROPOSAL No. S-7012	

FULL WATER QUENCH

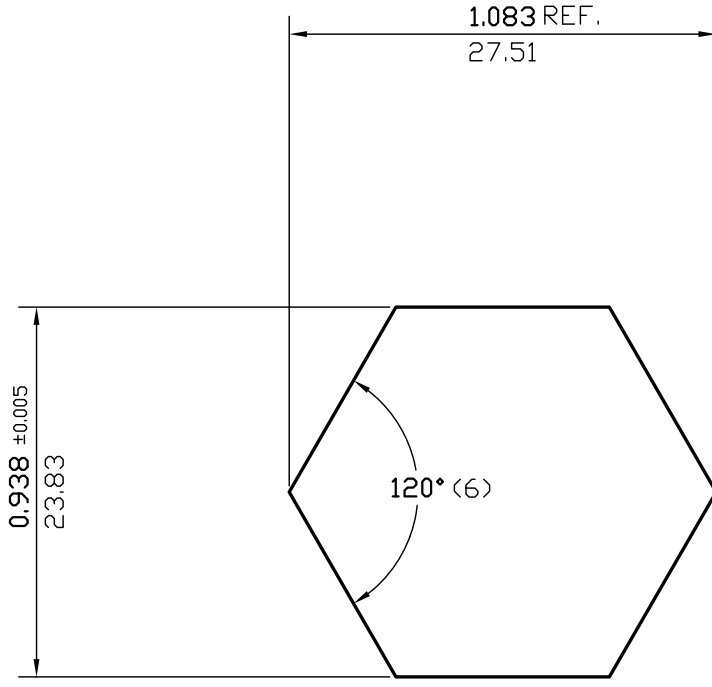

NOTE:
 THIS SHAPE WILL BE USED
 FOR SCREW MACHINE PARTS

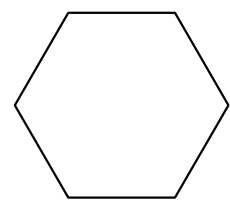

ACTUAL SIZE

WALL THICKNESS (AS SHOWN) EXCEPT AS SHOWN

DATE	REV	DESCRIPTION	BY		
03/17/23	2	REMOVED EXPOSED SURFACES	JASON		
08/20/99	1	REDRAWN	P.M.		
EST.AREA	0.762	IN. ²	EST.AREA	492	MM. ²
EST.WT.	0.914	LBS/FT.	EST.WT.	1.361	KG/M.
EST.PER.	3.249	IN.	EST.PER.	82.5	MM.
OUT PER.		IN.	OUT PER.		MM.
C.C.D.	1.083	IN.	C.C.D.	28	MM.
FACTOR	4	FINISH	M/F	ALLOY & TEMP.	
CKD BY		SCALE	2:1	DWN BY	C.P. DATE 10/29/97

CAN ART

ALUMINUM EXTRUSION INC.

85 PARKSHORE DRIVE
 BRAMPTON, ONT L6T 5M1
 TEL. NO. (905) 791-1464
 FAX NO. (905) 791-9151
 E-MAIL: canart@canart.com

THIS DRAWING IS NOT NECESSARILY A COPY OF YOUR ORIGINAL. PLEASE APPROVE DIMENSIONS AND TOLERANCES INDICATED. CAN ART ASSUMES NO RESPONSIBILITY EITHER TECHNICAL OR LEGAL FOR HAVING THIS SHAPE MADE. THE CUSTOMER AGREES TO FULLY PROTECT CAN ART ALUMINUM FROM CLAIMS OF OTHERS RESULTING FROM THIS SHAPE.

SIGNED: _____ DATE: _____